



Shenzhen Jinshunlaite Motor.,Ltd.

web : www.aslongdcmotor.com/www.aslongmotor.com

Email : sales@aslongmotor.com

ASLONG®

Mddel:JGB37-500

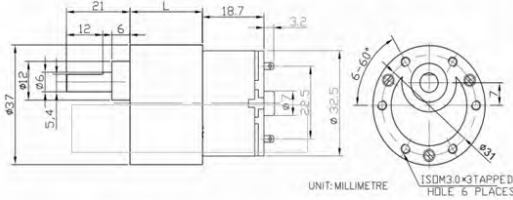

Model	No-load			Load				Stall		Weight	L
	Rated volt	Speed	Current	Speed	Current	Torque	Power	Torque	Current		
	V	±5%RPM	MA	±5%RPM	MA	KG.CM	W	KG.CM	MA	g	MM
JGB37-500-6.3K	12	1000	38	860	213	0.08	0.73	0.4	770	124	19
JGB37-500-10K	12	640	38	438	236	0.13	0.58	0.64	770	124	
JGB37-500-19K	12	340	38	275.6	177	0.24	0.69	1.2	770	129	22
JGB37-500-30K	12	210	38	160	221	0.43	0.73	1.86	770	129	
JGB37-500-56K	12	110	38	86.8	208	0.74	0.67	3.2	770	133	24
JGB37-500-90K	12	70	38	56	227	1.18	0.69	5.1	770	133	
JGB37-500-131K	12	50	38	34	170	1.89	0.67	7.5	770	137	26.5
JGB37-500-168K	12	40	38	31.2	199	2.79	0.91	9.65	770	137	
JGB37-500-270K	12	24	38	20.6	199	4.56	0.98	15	770	137	29
JGB37-500-506K	12	13	38	10.2	220	8.7	0.92	31	770	146	
JGB37-500-810K	12	8	38	6.5	200	11.6	0.78	37.5	770	146	

Model	No-load			Load				Stall		Weight	L
	Rated volt	Speed	Current	Speed	Current	Torque	Power	Torque	Current		
	V	±5%RPM	MA	±5%RPM	MA	KG.CM	W	KG.CM	MA	g	MM
JGB37-500-6.3K	24	960	30	740	89	0.06	0.5	0.22	330	124	19
JGB37-500-10K	24	600	30	462	85	0.1	0.48	0.35	330	124	
JGB37-500-19K	24	320	30	240	100	0.14	0.34	0.67	330	129	22
JGB37-500-30K	24	200	30	159.7	81	0.22	0.37	1.1	330	129	
JGB37-500-56K	24	100	30	82	80	0.92	0.78	2	330	133	24
JGB37-500-90K	24	66	30	55.5	79	1.12	0.79	3.2	330	133	
JGB37-500-131K	24	45	30	37.1	86	1.32	0.51	4.6	330	137	26.5
JGB37-500-168K	24	35	30	27.2	104	1.4	0.4	6	330	137	
JGB37-500-270K	24	22	30	18.8	105	3	0.59	9.48	330	137	29
JGB37-500-506K	24	12	30	9.3	107	9.13	0.88	18	330	146	
JGB37-500-810K	24	7	30	5.4	105	14.6	0.82	28.9	330	146	



Shenzhen Jinshunlaite Motor.,Ltd.

web : www.aslongdcmotor.com/www.aslongmotor.com

Email : sales@aslongmotor.com

ASLONG®

Mddel:JGB37-520

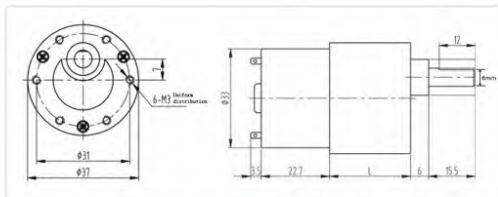

Reduction ratio	Rated Volt	No Load		AT Load			STALL		Gearbox Length
		SPEED	CURRENT	Torque	SPEED	Current	TOGQCE	CURRENT	
	V	RPM	mA	KG.cm	RPM	A	KG.CM	A	mm
6.3	12	960	120	0.3	670	400	1	400	19
10	12	600	120	0.5	420	400	1.65	400	19
18.8	12	320	120	0.67	224	400	3.1	400	22
30	12	200	120	1.5	140	400	5	400	22
56	12	107	120	2.8	75	400	9	400	24
90	12	66	120	4.5	46	400	15	400	24
131	12	45	120	6.5	32	400	21	400	26.5
168	12	35	120	8.4	25	400	25	400	26.5
270	12	22	120	13.5	16	400	25	400	26.5
506	12	12	120	18	8.5	400	25	400	29
810	12	7	120	22	5	400	25	400	29
6.3	24	960	50	0.3	670	200	1	200	19
10	24	600	50	0.5	420	200	1.65	200	19
18.8	24	320	50	0.67	224	200	3.1	200	22
30	24	200	50	1.5	140	200	5	200	22
56	24	107	50	2.8	75	200	9	200	24
90	24	66	50	4.5	46	200	15	200	24
131	24	45	50	6.5	32	200	21	200	26.5
168	24	35	50	8.4	25	200	25	200	26.5
270	24	22	50	13.5	16	200	25	200	26.5
506	24	12	50	18	8.5	200	25	200	29
810	24	7	50	22	5	200	25	200	29



Shenzhen Jinshunlaite Motor.,Ltd.
 web: www.aslongdcmotor.com/www.aslongmotor.com
 Email: sales@aslongmotor.com



Mddel:JGB37-520B

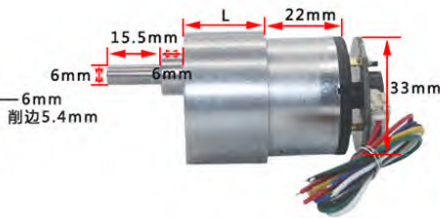
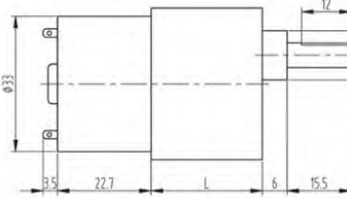
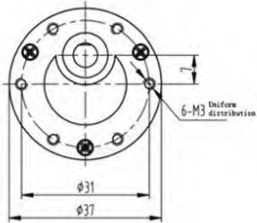

Reduction ratio	Rated Volt	No Load			AT Load		STALL		Gearbox Length mm
		SPEED RPM	CURRENT mA	Torque KG.cm	SPEED RPM	Current A	TOGQCE KG.CM	CURRENT A	
6.3	6	1000	70	0.4	800	0.45	0.5	1.2	19
10	6	600	70	0.5	500	0.45	0.8	1.2	19
19	6	300	70	1.1	265	0.45	1.6	1.2	22
30	6	200	70	1.7	166	0.45	2.5	1.2	22
56	6	100	70	3.2	90	0.45	4.5	1.2	24
90	6	70	70	5	55	0.45	7.5	1.2	24
131	6	45	70	7.5	38	0.45	12	1.2	26.5
168	6	35	70	9.5	30	0.45	15	1.2	26.5
270	6	20	70	15	18	0.45	24	1.2	26.5
506	6	12	70	28	10	0.45	35	1.2	29
810	6	7	70	35	6	0.45	35	1.2	29
6.3	12	1590	120	0.7	1200	1	1	2.3	19
10	12	1000	120	1	770	1	1.6	2.3	19
19	12	530	120	2.2	407	1	3.1	2.3	22
30	12	333	120	3.5	250	1	5	2.3	22
56	12	178	120	6.5	140	1	9	2.3	24
90	12	110	120	10	85	1	15	2.3	24
131	12	76	120	15	58	1	24	2.3	26.5
168	12	60	120	19	46	1	31	2.3	26.5
270	12	37	120	30	28	1	35	2.3	26.5
506	12	20	120	35	15	1	35	2.3	29
810	12	12	120	35	9	1	35	2.3	29



Encoder wiring diagram:

- ① Red Wire - positive power supply of motor(+) (change positive and negative of motor the rotation will change)
- ② White Wire - negative power supply of motor(-) (change positive and negative of motor the rotation will change)
- ③ Yellow Wire - signal feedback (motor one turn has 11 signals)
- ④ Green Wire - signal feedback (motor one turn has 11 signals)
- ⑤ Blue Wire - positive of encoder power supply(+)(3.3-5V),cannot be wrong
- ⑥ Black Wire - negative of encoder power supply(-)(3.3-5V),cannot be wrong

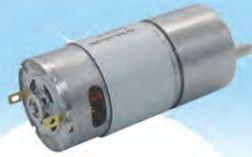

Shenzhen Jinshunlaite Motor.,Ltd.

web: www.aslongdcmotor.com/www.aslongmotor.com

Email: sales@aslongmotor.com

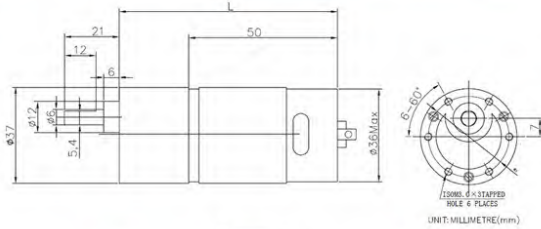

Mdel:JGB37-545



100	Rated Volt	No Load			AT Load			STALL		Gearbox Length
		SPEED	CURRENT	Torque	SPEED	Current	TOGQCE	CURRENT		
	V	RPM	mA	KG.cm	RPM	A	KG.CM	A	mm	
6.3	12	1000	200	0.5	800	1	3	3.8	19	
10	12	625	200	0.8	530	1	5	3.8	19	
19	12	332	200	1.4	280	1	9.4	3.8	22	
30	12	208	200	1.5	176	1	15	3.8	22	
56	12	110	200	4.5	95	1	28	3.8	24	
90	12	70	200	7.2	58	1	35		24	
131	12	47	200	10.5	40	1	35		26.5	
168	12	37	200	13.5	30	1	35		26.5	
270	12	23	200	21.6	19	1	35		26.5	
506	12	12	200	35	10	1	35		29	
810	12	8	200	35	6.5	1	35		29	
6.3	24	960	200	2.5	740	1	6	2.8	19	
10	24	600	200	4	460	1	10	2.8	19	
19	24	320	200	7	250	1	19	2.8	22	
30	24	200	200	12	150	1	30	2.8	22	
56	24	107	200	22	82	1	35		24	
90	24	66	200	35	50	1	35		24	
131	24	45	200	35	35	1	35		26.5	
168	24	35	200	35	26	1	35		26.5	
270	24	22	200	35	17	1	35		26.5	
506	24	12	200	35	9	1	35		29	
810	24	7	200	35	5	1	35		29	



Shenzhen Jinshunlaite Motor.,Ltd.

web: www.aslongdcmotor.com/www.aslongmotor.com

Email: sales@aslongmotor.com

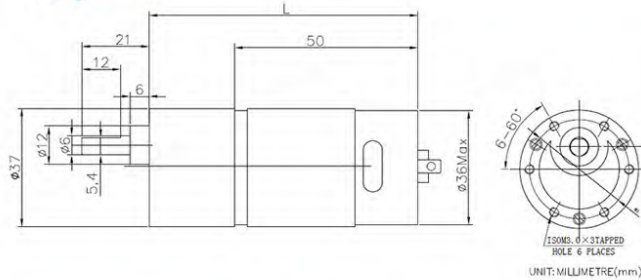

Mdel:JGB37-545B



Reduction ratio	Rated Volt	No Load			AT Load			STALL		Gearbox Length
		SPEED	CURRENT	Torque	SPEED	Current	TOGQCE	CURRENT		
	V	RPM	mA	KG.cm	RPM	A	KG.CM	A	mm	
6.3	6	500	100	0.2	400	0.45	1.5	1.8	19	
10	6	312	100	0.4	260	0.45	2.5	1.8	19	
19	6	166	100	0.8	140	0.45	4.7	1.8	22	
30	6	104	100	1.2	88	0.45	7.5	1.8	22	
56	6	55	100	2.2	47	0.45	14	1.8	24	
90	6	35	100	3.2	29	0.45	22	1.8	24	
131	6	24	100	5.2	20	0.45	32	1.8	26.5	
168	6	19	100	6.7	15	0.45	35		26.5	
270	6	11	100	10	9	0.45	35		26.5	
506	6	6	100	20	5	0.45	35		29	
810	6	4	100	32	3	0.45	35		29	
6.3	12	1000	200	0.5	800	1	3	5	19	
10	12	625	200	0.8	530	1	5	5	19	
19	12	332	200	1.4	280	1	9.4	5	22	
30	12	208	200	1.5	176	1	15	5	22	
56	12	110	200	4.5	95	1	28	5	24	
90	12	70	200	7.2	58	1	35		24	
131	12	47	200	10.5	40	1	35		26.5	
168	12	37	200	13.5	30	1	35		26.5	
270	12	23	200	21.6	19	1	35		26.5	
506	12	12	200	35	10	1	35		29	
810	12	8	200	35	6.5	1	35		29	
6.3	24	2000	400	1	1660	1.9	6	11	19	
10	24	1250	400	1.6	1050	1.9	10	11	19	
19	24	660	400	3	558	1.9	19	11	22	
30	24	415	400	3.9	350	1.9	30	11	22	
56	24	223	400	9	187	1.9	35		24	
90	24	140	400	14	115	1.9	35		24	
131	24	95	400	20	80	1.9	35		26.5	
168	24	75	400	26	62	1.9	35		26.5	
270	24	46	400	35	38	1.9	35		26.5	
506	24	24	400	35	20	1.9	35		29	
810	24	15	400	35	13	1.9	35		29	



Shenzhen Jinshunlaite Motor.,Ltd.

web: www.aslongdcmotor.com/www.aslongmotor.com

Email: sales@aslongmotor.com



Model: JGB37-550

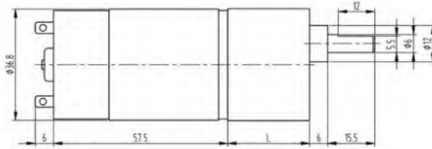
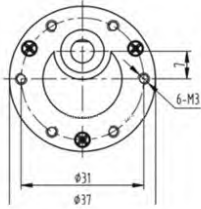

Reduction ratio коэффициент умножения	Voltage вольты		No load		Rated load Номинальная нагрузка			Stall (Maximum) (максимальная)			L The length of the Gearbox мм
	Range	Rated	Speed r/min	Current A	Speed r/min	Current A	Torque kg.cm	Torque kg.cm	Current A		
1:00											
6.3	3-9V	6V	1150	≤0.7	920	≤1.5	0.5	1	3		19
10	3-9V	6V	725	≤0.7	580	≤1.5	0.9	1.7	3		19
19	3-9V	6V	380	≤0.7	240	≤1.5	1.6	3.2	3		22
30	3-9V	6V	240	≤0.7	160	≤1.5	2.5	5	3		22
56	3-9V	6V	130	≤0.7	100	≤1.5	5	9.5	3		24
90	3-9V	6V	80	≤0.7	64	≤1.5	7.5	15.3	3		24
131	3-9V	6V	55	≤0.7	45	≤1.5	11	22	3		26.5
168	3-9V	6V	43	≤0.7	33	≤1.5	14	28	3		26.5
270	3-9V	6V	26	≤0.7	20	≤1.5	20				29
506	3-9V	6V	14	≤0.7	11	≤1.5	25	≤35KG	Prohibited Запрещено		29
810	3-9V	6V	9	≤0.7	7	≤1.5	30				29
6.3	6-18V	12V	2300	≤1	1900	≤2.5	1.2	2.1	6		19
10	6-18V	12V	1450	≤1	1160	≤2.5	0.5	3.4	6		19
19	6-18V	12V	770	≤1	600	≤2.5	1	6.3	6		22
30	6-18V	12V	480	≤1	380	≤2.5	1.5	10	6		22
56	6-18V	12V	260	≤1	200	≤2.5	3	19	6		24
90	6-18V	12V	160	≤1	130	≤2.5	4.5	30	6		24
131	6-18V	12V	110	≤1	88	≤2.5	7				26.5
168	6-18V	12V	86	≤1	69	≤2.5	9				26.5
270	6-18V	12V	53	≤1	42	≤2.5	14	≤35KG			29
506	6-18V	12V	28	≤1	22	≤2.5	26				29
810	6-18V	12V	18	≤1	14	≤2.5	28				29



Shenzhen Jinshunlaite Motor.,Ltd.

web: www.aslongdcmotor.com/www.aslongmotor.com

Email: sales@aslongmotor.com



Mddel:JGB37-555

Model	Rated voltage	No load			Rated			Stall			L size
		Speed	Current	Speed	Current	Torque	Output power	Torque	Current	Weight	
	V	RPM	A	RPM	A	NM	W	NM	A	g	MM
JGB37-555-6.25K	12	800	0.2	650	1.2	0.12	8.22	0.35	6.5	295	19
JGB37-555-10K	12	500	0.2	407	1.2	0.2	8.56	0.7	6.5	295	19
JGB37-555-18.75K	12	267	0.2	217	1.2	0.37	8.44	1	6.5	300	22
JGB37-555-30K	12	167	0.2	136	1.2	0.6	8.56	1.6	6.5	300	22
JGB37-555-56.25K	12	89	0.2	72	1.2	1.12	8.52	3	6.5	305	24
JGB37-555-90K	12	56	0.2	45	1.2	1.8	8.56	5	6.5	305	24
JGB37-555-131.25K	12	38	0.2	31	1.2	2.6	8.48	7	6.5	310	26.5
JGB37-555-168.75K	12	30	0.2	24	1.2	3.36	8.52	9	6.5	310	26.5
JGB37-555-270K	12	19	0.2	15	1.2	5.4	8.56	15	6.5	315	29
JGB37-555-506.25K	12	10	0.2	8	1.2	7	5.92	25	6.5	315	29
JGB37-555-810K	12	6	0.2	5	1.2	7	3.7	35	6.5	315	29
JGB37-555-6.25K	24	800	0.1	650	0.9	0.12	8.22	0.5	4	295	19
JGB37-555-10K	24	500	0.1	407	0.9	0.2	8.56	0.8	4	295	19
JGB37-555-18.75K	24	267	0.1	217	0.9	0.37	8.44	1.46	4	300	22
JGB37-555-30K	24	167	0.1	136	0.9	0.6	8.56	2.3	4	300	22
JGB37-555-56.25K	24	89	0.1	72	0.9	1.12	8.52	4.37	4	305	24
JGB37-555-90K	24	56	0.1	45	0.9	1.8	8.56	7	4	305	24
JGB37-555-131.25K	24	38	0.1	31	0.9	2.6	8.48	10	4	310	26.5
JGB37-555-168.75K	24	30	0.1	24	0.9	3.36	8.52	15	4	310	26.5
JGB37-555-270K	24	19	0.1	15	0.9	5.4	8.56	25	4	315	29
JGB37-555-506.25K	24	10	0.1	8	0.9	7	5.92	35	4	315	29
JGB37-555-810K	24	6	0.1	5	0.9	7	3.7	45	4	315	29

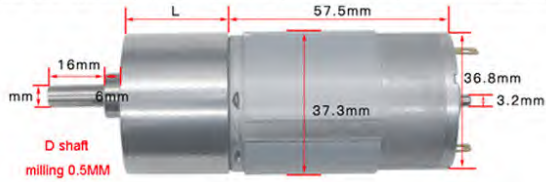
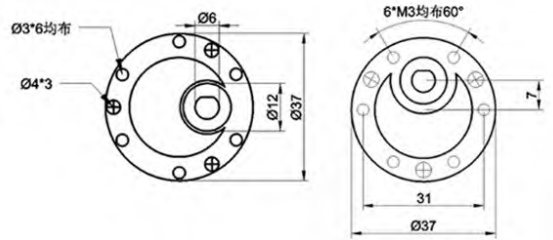
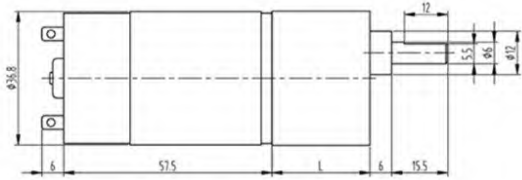

Shenzhen Jinshunlaite Motor.,Ltd.

web: www.aslongdcmotor.com/www.aslongmotor.com

Email: sales@aslongmotor.com



Mddel:JGB37-31ZY

DIRECTION OF ROTATION

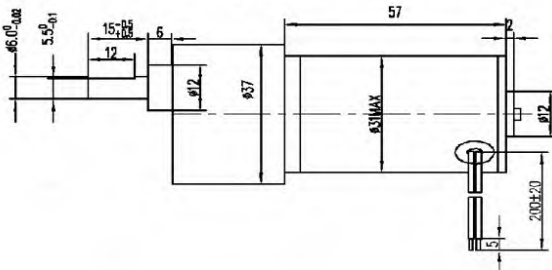
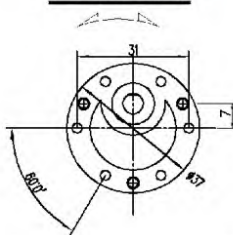

Rated Volt	No Load			AT Load			STALL		Gearbox Length
	SPEED RPM	CURRENT mA	Torque KG.cm	SPEED RPM	Current A	OUTPUT W	TORQUE KG.CM	CURRENT A	
12	1270	350	1.3	1050	1	10	3	6.5	19
12	800	350	2	660	1	10	5	6.5	19
12	420	350	3.8	350	1	10	9	6.5	22
12	260	350	6	220	1	10	15	6.5	22
12	140	350	11.2	110	1	10	27	6.5	24
12	90	350	18	73	1	10	35	6.5	24
12	60	350	26	50	1	10	35	6.5	26.5
12	47	350	33	40	1	10	35	6.5	26.5
12	30	350	35	24	1	10	35	6.5	26.5
12	16	350	35	13	1	10	35	6.5	29
12	10	350	35	8	1	10	35	6.5	29
24	1270	280	1.3	1050	1	20	1.3	4.4	19
24	800	280	2	660	1	20	2	4.4	19
24	420	280	3.8	350	1	20	3.8	4.4	22
24	260	280	6	220	1	20	6	4.4	22
24	140	280	11.2	110	1	20	11.2	4.4	24
24	90	280	18	73	1	20	18	4.4	24
24	60	280	26	50	1	20	26	4.4	26.5
24	47	280	33	40	1	20	33	4.4	26.5
24	30	280	35	24	1	20	35	4.4	26.5
24	16	280	35	13	1	20	35	4.4	29
24	10	280	35	8	1	20	35	4.4	29



Shenzhen Jinshunlaite Motor.,Ltd.

web : www.aslongdcmotor.com/www.aslongmotor.com

Email : sales@aslongmotor.com



Mdel:JGB37-3530

Reduction ratio	Rated Volt	No Load			AT Load			STALL		Gearbox Length
		SPEED	CURRENT	Torque	SPEED	Current	OUTPUT	TOGQCE	CURRENT	
6.25	12	1600	120	0.3	1120	400	4.8	1	1.2	19
10	12	1000	120	0.38	800	400	4.8	1.52	1.2	19
18.8	12	531	120	0.7	424	400	4.8	2.8	1.2	22
30	12	333	120	1.14	266	400	4.8	4.5	1.2	22
56	12	178	120	2.1	412	400	4.8	8.4	1.2	24
90	12	111	120	3.4	88	400	4.8	13	1.2	24
131	12	76	120	5	60	400	4.8	20	1.2	26.5
168	12	59	120	6.3	47	400	4.8	25	1.2	26.5
270	12	37	120	10	29	400	4.8	40	1.2	26.5
506	12	20	120	19	16	400	4.8	Ban	1.2	29
810	12	12	120	30	9	400	4.8	Ban	1.2	29
6.25	24	960	50	0.2	672	100	2.5	1	0.9	19
10	24	600	50	0.29	480	100	2.5	1.16	0.9	19
18.8	24	319	50	0.54	255	100	2.5	2.1	0.9	22
30	24	200	50	1.1	160	100	2.5	4.4	0.9	22
56	24	107	50	1.6	85	100	2.5	6.4	0.9	24
90	24	66	50	2.61	52	100	2.5	10	0.9	24
131	24	45	50	3.7	36	100	2.5	14.8	0.9	26.5
168	24	35	50	4.8	28	100	2.5	19	0.9	26.5
270	24	22	50	7.8	18	100	2.5	31	0.9	26.5
506	24	12	50	14	10	100	2.5	Ban	0.9	29
810	24	7	50	23	5.6	100	2.5	Ban	0.9	29

DIRECTION OF ROTATION

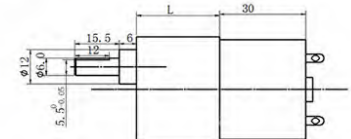
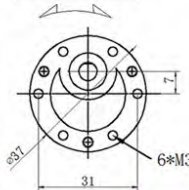

L is gearbox length



Shenzhen Jinshunlaite Motor.,Ltd.

web : www.aslongdcmotor.com/www.aslongmotor.com

Email : sales@aslongmotor.com



Mdel:JGB37-3530B

DIRECTION OF ROTATION

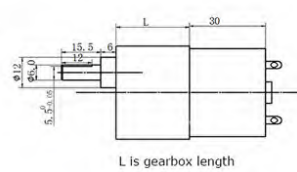
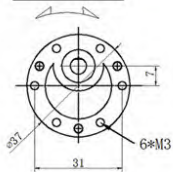

L is gearbox length

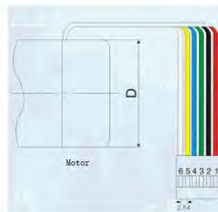

Encoder wiring diagram:

1. MOTOR+
2. MOTOR-
3. HALL SENSOR GND
4. HALL SENSOR Vcc
5. HALL SENSOR A Vout
6. HALL SENSOR B Vout

Reduction ratio	Rated Volt	No Load			AT Load			STALL		Gearbox Length
		SPEED	CURRENT	Torque	SPEED	Current	OUTPUT	TOGQCE	CURRENT	
6.25	12	1600	120	0.3	1120	400	4.8	1	1.2	19
10	12	1000	120	0.38	800	400	4.8	1.52	1.2	19
18.8	12	531	120	0.7	424	400	4.8	2.8	1.2	22
30	12	333	120	1.14	266	400	4.8	4.5	1.2	22
56	12	178	120	2.1	412	400	4.8	8.4	1.2	24
90	12	111	120	3.4	88	400	4.8	13	1.2	24
131	12	76	120	5	60	400	4.8	20	1.2	26.5
168	12	59	120	6.3	47	400	4.8	25	1.2	26.5
270	12	37	120	10	29	400	4.8	40	1.2	26.5
506	12	20	120	19	16	400	4.8	Ban	1.2	29
810	12	12	120	30	9	400	4.8	Ban	1.2	29
6.25	24	960	50	0.2	672	100	2.5	1	0.9	19
10	24	600	50	0.29	480	100	2.5	1.16	0.9	19
18.8	24	319	50	0.54	255	100	2.5	2.1	0.9	22
30	24	200	50	1.1	160	100	2.5	4.4	0.9	22
56	24	107	50	1.6	85	100	2.5	6.4	0.9	24
90	24	66	50	2.61	52	100	2.5	10	0.9	24
131	24	45	50	3.7	36	100	2.5	14.8	0.9	26.5
168	24	35	50	4.8	28	100	2.5	19	0.9	26.5
270	24	22	50	7.8	18	100	2.5	31	0.9	26.5
506	24	12	50	14	10	100	2.5	Ban	0.9	29
810	24	7	50	23	5.6	100	2.5	Ban	0.9	29



